

Standard Features

- ◆ Corner rings are webbed stainless steel external rings with leather chafe patches or pressed stainless steel rings with load straps.
- ◆ All seams will have 2 to 3 rows of 3-step stitching, depending on size.
- ◆ Patches will be of the Fan/Radial type.
- ◆ Yachts over 30 feet (9.14mt) will have a two-ply head and clew area of which each will be approximately 22% of the leech length.
- ◆ Sails include draft (trim) stripe
- ◆ Polyester or Spectra Leech & foot lines.
- ◆ Tell-tails and one tell tail window.
- ◆ Heavy Duty sailbag.

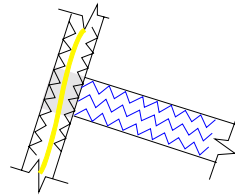

2 or 3 rows of contrasting 3-step stitching and internal leechline chafe guard

Two Ply overlay for maximum strength and load dispersion.

Optional Features

- ◆ Seamkote
- ◆ [Tradewinds Specifications](#)
- ◆ Reefs in jibs
- ◆ Sail Numbers



Strapped-in rings for ultimate durability.

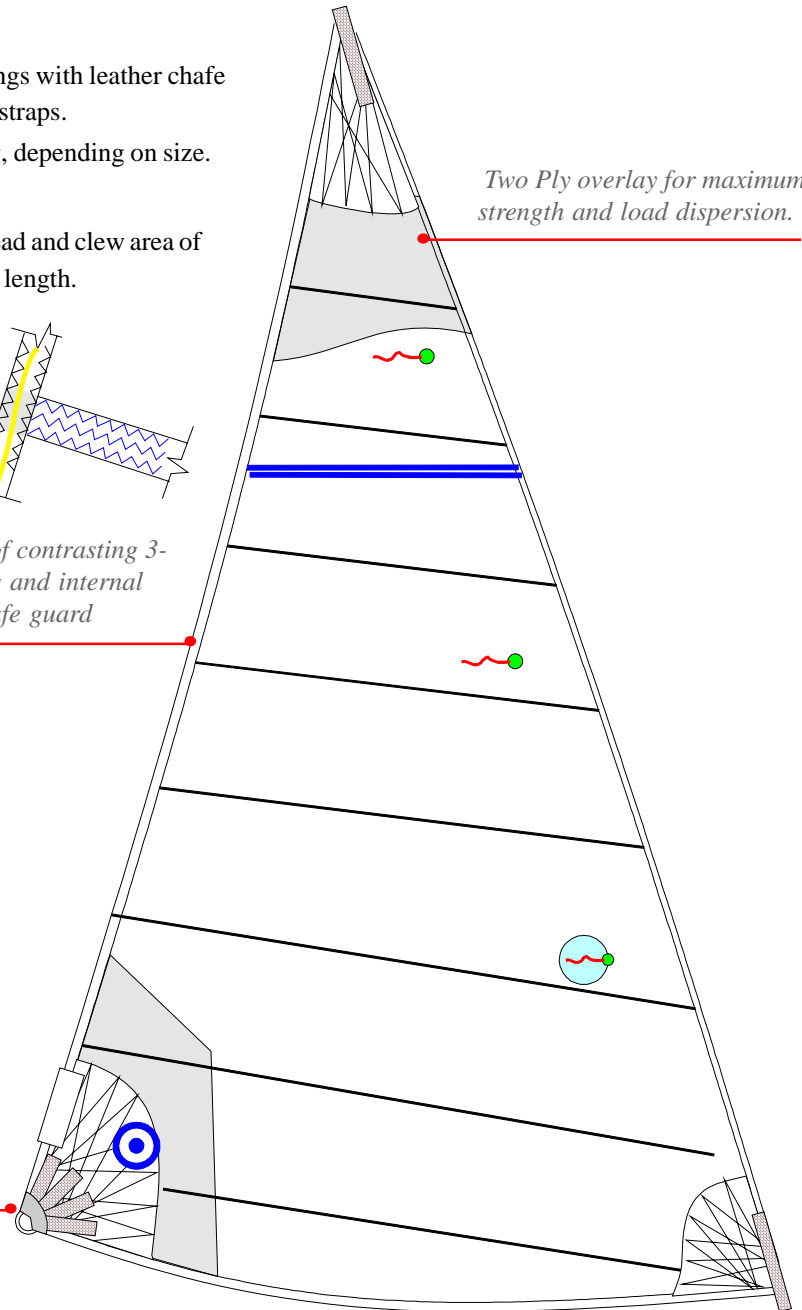

Quality, Service, Value

- ◆ Every sail we build comes with the assurance of a two year warranty of quality, service and value.
- ◆ If you ever need service, our consultants will direct you to the nearest of our worldwide network of Service lofts.
- ◆ No matter where in the world your sailing takes you, we are there to help.
- ◆ For further information, contact your Neil Pryde consultant by dialing 1-203-874-6984 or <http://www.neilprydesails.com>